

01 LANDSCAPE PLAN (NORTH ADDITION)

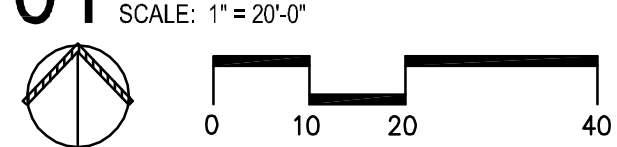

LANDSCAPE NOTES

- Contractor shall verify all existing and proposed site elements and notify Architect of any discrepancies. Survey data of existing conditions was supplied by others.
- Contractor shall locate all existing underground utilities and notify Architect of any conflicts. Contractor shall exercise caution when working in the vicinity of underground utilities.
- Contractor is responsible for obtaining all required landscape and irrigation permits.
- Contractor to provide a minimum 2% slope away from all structures.
- All planting beds and lawn areas to be separated by steel edging. No steel to be installed adjacent to sidewalks or curbs.
- All landscape areas to be 100% irrigated with an underground automatic irrigation system and shall include rain and freeze sensors.
- All lawn areas to be Solid Sod Bermudagrass, unless otherwise noted on the drawings.

MAINTENANCE NOTES

- The Owner, tenant and their agent, if any, shall be jointly and severally responsible for the maintenance of all landscape.
- All landscape shall be maintained in a neat and orderly manner at all times. This shall include mowing, edging, pruning, fertilizing, watering, weeding and other such activities common to landscape maintenance.
- All landscape areas shall be kept free of trash, litter, weeds and other such material or plants not part of this plan.
- All plant material shall be maintained in a healthy and growing condition as is appropriate for the season of the year.
- All plant material which dies shall be replaced with plant material of equal or better value.
- Contractor shall provide separate bid proposal for one year's maintenance to begin after final acceptance.

GENERAL LAWN NOTES

- Fine grade areas to achieve final contours indicated on civil plans.
- Adjust contours to achieve positive drainage away from buildings. Provide uniform rounding at top and bottom of slopes and other breaks in grade. Correct irregularities and areas where water may stand.
- All lawn areas to receive solid sod shall be left in a maximum of 1" below final finish grade. Contractor to coordinate operations with on-site Construction Manager.
- Imported topsoil shall be natural, friable soil from the region, known as bottom and soil, free from lumps, clay, toxic substances, roots, debris, vegetation, stones, containing no salt and black to brown in color.
- All lawn areas to be fine graded, irrigation trenches completely settled, and finish grade approved by the Owner's Construction Manager or Architect prior to installation.
- All rocks 3/4" diameter and larger, dirt clods, sticks, concrete spots, etc. shall be removed prior to placing topsoil and any lawn installation.
- Contractor shall provide (1") one inch of imported topsoil on all areas to receive lawn.

IRRIGATION REPAIR SPECIFICATIONS

- Contractor shall perform site visit prior to bidding and construction, to review extent of existing irrigation system.
- Contractor shall be responsible for verifying conditions of existing irrigation system. Contractor shall be responsible for maintaining the integrity of existing irrigation where possible, and if not, repair as needed, including but not limited to irrigation controller, meter, sleeving, etc.

LAWN REPAIR NOTES

- All lawn areas damaged during construction to be repaired with solid sod and raked free of debris.
- Adjust damaged areas to achieve positive drainage away from buildings. Provide uniform rounding at top and bottom of slopes and other breaks in grade. Correct irregularities and areas where water may stand.
- All areas to be repaired must be planted by hand to cover area completely. Insure edges of sod are touching. Top dress joints by hand with compost to fill voids.
- Roll repaired areas to achieve a smooth, even surface, free from unnatural undulations.

SOLID SOD NOTES

- Fine grade areas to achieve final contours indicated. Leave areas to receive topsoil 3" below final desired grade in planting areas and 1" below final grade in turf areas.
- Adjust contours to achieve positive drainage away from buildings. Provide uniform rounding at top and bottom of slopes and other breaks in grade. Correct irregularities and areas where water may stand.
- All lawn areas to receive solid sod shall be left in a maximum of 1" below final finish grade. Contractor to coordinate operations with on-site Construction Manager.
- Contractor to coordinate with on-site Construction Manager for availability of existing topsoil.
- Plant sod by hand to cover indicated area completely. Insure edges of sod are touching. Top dress joints by hand with topsoil to fill voids.
- Roll grass areas to achieve a smooth, even surface, free from unnatural undulations.
- Water sod thoroughly as sod operation progresses.
- Contractor shall maintain all lawn areas until final acceptance. This shall include, but not limited to: mowing, watering, weeding, cultivating, cleaning and replacing dead or bare areas to keep plants in a vigorous, healthy condition.
- Contractor shall guarantee establishment of an acceptable turf area and shall provide replacement from local supply if necessary.
- If installation occurs between September 1 and March 1, all sod areas to be over-seeded with Winter Ryegrass, at a rate of (4) pounds per one thousand (1000) square feet.

GRAPHIC PLANT LEGEND

- EXISTING TREE TO REMAIN
- LIVE OAK, 3" CAL.
- CEDAR ELM, 3" CAL.
- PURPLE WINTERCREEPER 4" pots, 12" o.c.

Exhibit E

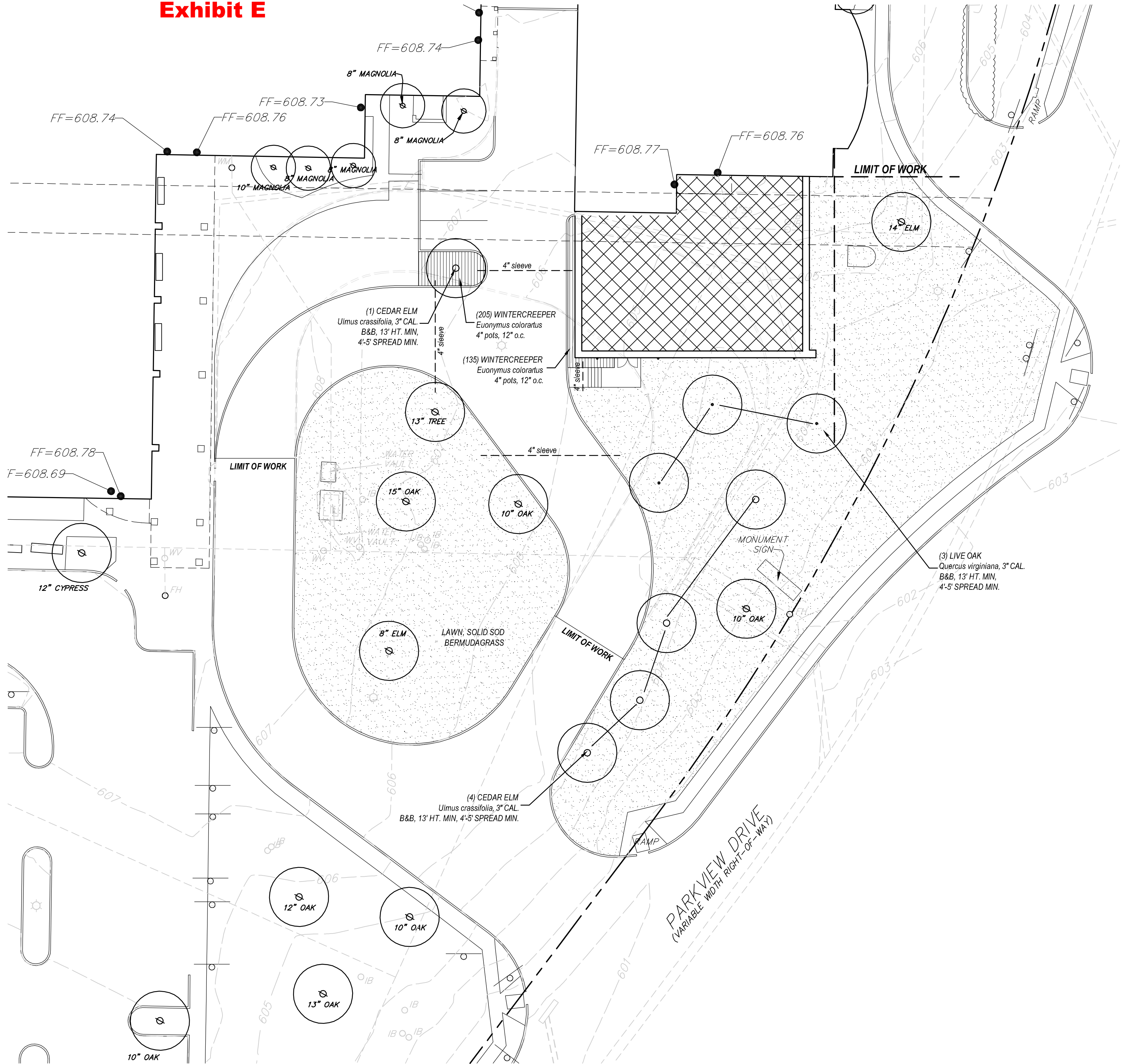

02 LANDSCAPE PLAN (SOUTH ADDITION)

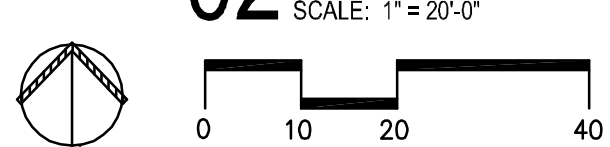

5646 MILTON STREET, SUITE 426  
DALLAS, TEXAS 75206  
[WWW.GLENN-PARTNERS.COM](http://WWW.GLENN-PARTNERS.COM)  
COPYRIGHT © 2017 GLENN | PARTNERS

MEDLIN MIDDLE SCHOOL -  
ADDITION AND RENOVATION  
NORTHWEST INDEPENDENT SCHOOL DISTRICT  
601 PARKVIEW DRIVE  
TROPHY CLUB, TEXAS 76262

NO	REVISION	DATE

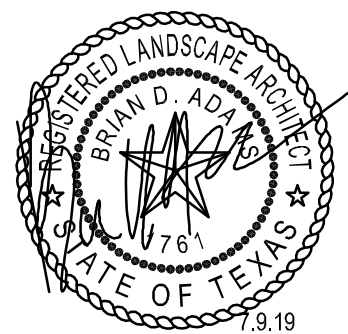

GLENN | PARTNERS PROJECT NO. 18-024

L01-01  
LANDSCAPE  
PLAN

SITE PLAN APPLICATION  
07.09.2019